



Acme Sanitary Ware Co Ltd

Acme Building, 22-28 Nanking Street, Kowloon, Hong Kong
 Tel: 2388 7171 Fax: 2710 8012
 E-mail: acme@acmesanitary.com.hk
 Website: www. acmesanitaryware.com.hk

PROJECT		REF		REV	ITEM CODE	
LOCATION		DATE			PAGE	

SANITARY WARE SPECIFICATION SHEET

Item Descriptions	Mediclinics (Spain) horizontal wall mounted polyethylene and stainless steel cover baby changing station	<div>Illustration/ Drawing</div> <div></div>
Dimensions	L570 x W860 x H565 mm	
Model	CP0016HCS	
Material	Polyethylene / Stainless Steel	
Manufacturer	Mediclinics, S.A. (Spain)	
Supplier	Acme Sanitary Ware Co. Ltd Mr. Eric Wong/ Mr. Wilson Hung	
Contact Tel/Fax	(852) 2388-7171 / (852) 2710-8012	<div></div> <div></div> <div></div>
E-mail	acme@acmesanitary.com.hk	
Website	www.acmesanitary.com.hk	
General Description Surface-mounted baby changing stations made of bacterial- esistant polypropylene (CP0016H and CP0016HCS) and with stainless steel AISI 304 exterior (only CP0016HCS) BabyMedi ® changing stations offer a very high level of safety and cleanliness being the ideal solution for public spaces such as, shopping centers, airports, public buildings, childcare centres, etc. Model suitable for high traffic facilities with high strength and durability. Their trendy and stylish design, allow these baby changing stations to blend into any space perfectly. Biocote® antimicrobial additive, based on ion silver technology, is embedded into its own surface, promoting an easy cleaning and reducing the growth of odor causing and staining microbes. BabyMedi ® baby changing stations are supplied (inside the packing box) with child protection straps made of nylon. A pair of bag hooks (one at the right side and the other one at the left) help to keep personal belongings close and at hand. BabyMedi ® units fully comply with the EN 12221-1 and EN 12221-2 standards that require baby changing stations be able to support a 50 Kg static load test during one hour. Moreover, units tested in our own laboratories have withstood loads over 100 kg.		
Technical Specifications		
Dimensions	L:860 x W:100 (closed)/ 570 (open) x H:480 mm	
Weight (empty)	12.3 Kg (CP0016H) 16.0 Kg (CP0016HCS)	
Liner dispenser capacity	80 units	
Recommended installation height	800 mm at lowest point	
Recommended installation height (handicapped)	700 mm at lowest point	

* All information of the above is for the reference only. No prior notice is made if any changes.

Source: A



Acme Sanitary Ware Co Ltd

Acme Building, 22-28 Nanking Street, Kowloon, Hong Kong

Tel: 2388 7171 Fax: 2710 8012

E-mail: acme@acmesanitary.com.hk

Website: www.acmesanitaryware.com.hk

PROJECT		REF		REV	ITEM CODE	
LOCATION		DATE			PAGE	

SANITARY WARE SPECIFICATION SHEET

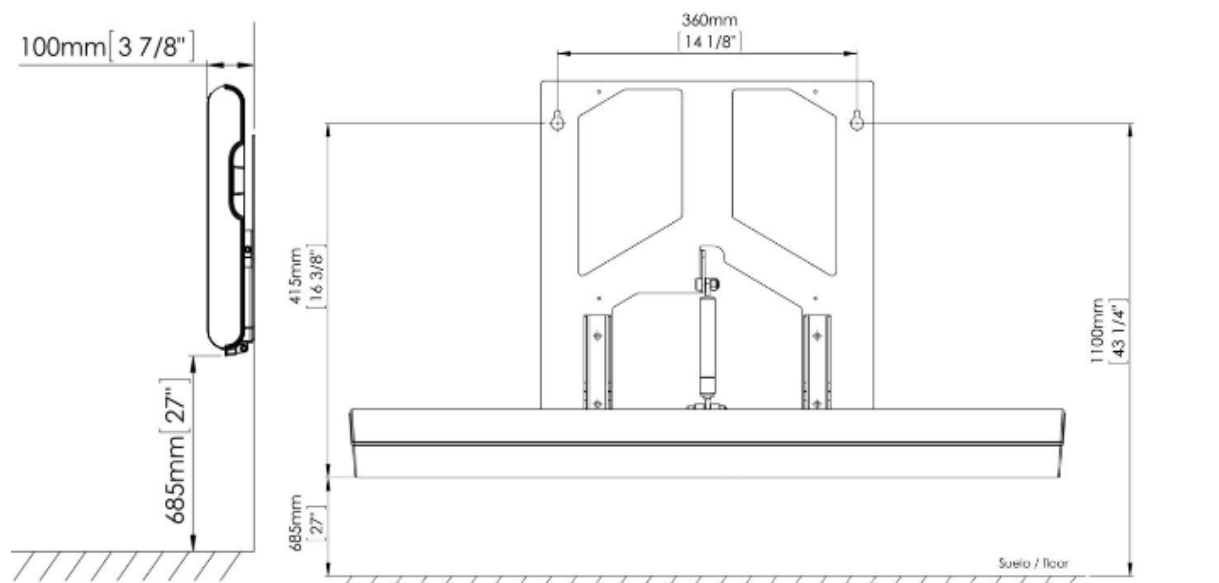

COMPONENT	No.	CODE
Label	1	RC9691020SMD
Shock absorber CP0016H	2	RC9161001SMD
Lock + key	3	RC9483003SMD
Key	4	RC99065
Protective liners	5	CN0020
Shock absorber CP0016HCS	6	RC9161002SMD

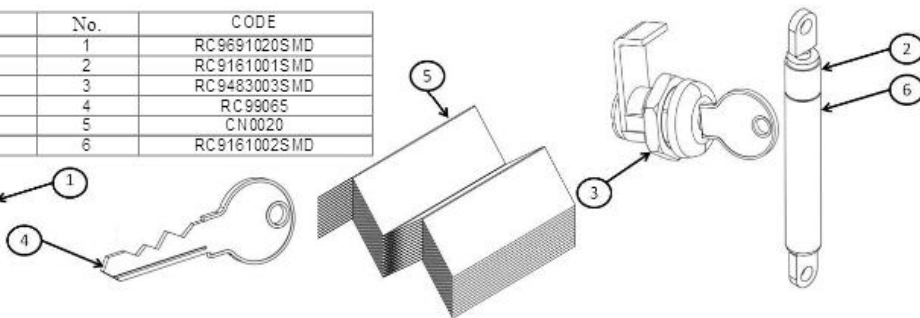

https://www.youtube.com/watch?v=0yHMXM_PFQI&feature=youtu.be

* All information of the above is for the reference only. No prior notice is made if any changes.

Source: A